

## Angle Rings

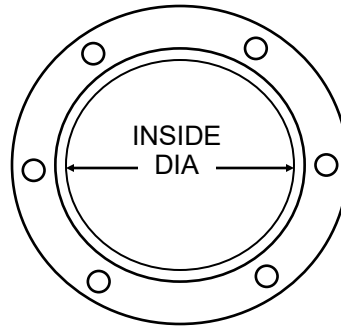
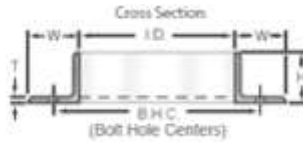
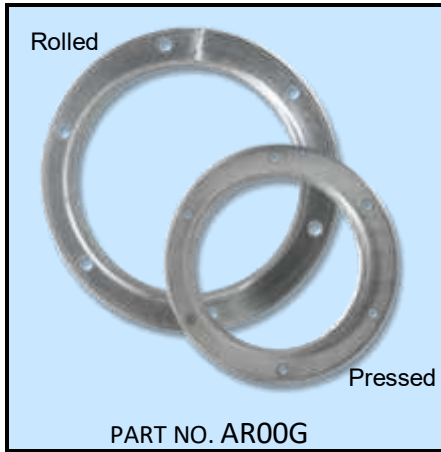

PRESSED RING SHOWN

- Galvanized standard
- Mild steel & stainless steel available
- Rubber gaskets available
- 3" to 5" pressed
- 6" and up rolled
- Fasteners not included
- Flat flange available with custom whole pattern

SIZE	PART #	INSIDE DIA	HEIGHT	WIDTH	THICKNESS	BOLT HOLE CENTERS	NO. OF BOLT HOLES	SIZE OF BOLT HOLES	WT.	PRICE GALV.
3"	AR03G	3-1/16"	7/8"	1"	10 ga.	4-5/16"	6	9/32"	0.70	
4"	AR04G	4 -1/16"	15/16"	1"	10 ga.	5-5/16"	6	9/32"	0.85	
5"	AR05G	5-1/16"	1"	1"	10 ga.	6-5/16"	6	9/32"	1.20	
6"	AR06G	6-1/8"	1-1/4"	1-1/4"	1/8"	7-5/16"	6	3/8"	1.75	
7"	AR07G	7-1/8"	1-1/4"	1-1/4"	1/8"	8-1/2"	6	3/8"	2.00	
8"	AR08G	8-1/8"	1-1/4"	1-1/4"	1/8"	9-9/16"	6	3/8"	2.25	
9"	AR09G	9-1/8"	1-1/8"	1 1/4"	1/8"	10-5/8"	6	3/8"	2.50	
10"	AR10G	10-1/8"	1-1/4"	1-1/4"	1/8"	11-13/16"	6	3/8"	2.75	
11"	AR11G	11-1/8"	1-1/4"	1-1/4"	1/8"	12-3/4"	6	3/8"	3.00	
12"	AR12G	12-1/8"	1-1/2"	1-1/2"	1/8"	14"	8	7/16"	4.00	
13"	AR13G	13-1/8"	1-1/2"	1-1/2"	1/8"	15"	8	7/16"	4.25	
14"	AR14G	14-1/8"	1-1/2"	1-1/2"	1/8"	16"	8	7/16"	4.75	CALL
15"	AR15G	15-1/8"	1-1/2"	1-1/2"	1/8"	17"	8	7/16"	5.00	FOR
16"	AR16G	16-1/8"	1-1/2"	1-1/2"	3/16"	18"	8	7/16"	8.00	PRICING
17"	AR17G	17-1/8"	1-1/2"	1-1/2"	3/16"	19"	8	7/16"	8.25	
18"	AR18	18-1/8"	1-1/2"	1-1/2"	3/16"	20"	8	7/16"	8.50	
20"	AR20G	20-1/8"	1-1/2"	1-1/2"	3/16"	21-3/4"	12	7/16"	9.50	
22"	AR22G	22-1/8"	1-1/2"	1-1/2"	3/16"	23-3/4"	12	7/16"	10.75	
24"	AR24G	24-1/8"	1-1/2"	1-1/2"	3/16"	25-7/8"	12	7/16"	11.50	
26"	AR26G	26-1/8"	2"	2"	3/16"	28-3/8"	16	7/16"	15.50	
28"	AR28G	28-1/8"	2"	2"	3/16"	30-3/8"	16	7/16"	18.00	
30"	AR30G	30-1/8"	2"	2"	3/16"	32-3/8"	16	7/16"	19.50	
32"	AR32G	32-1/8"	2"	2"	3/16"	34-3/8"	16	7/16"	20.00	
34"	AR34G	34-1/8"	2"	2"	3/16"	36-3/8"	16	7/16"	22.50	
36"	AR36G	36-1/8"	2"	2"	3/16"	38-3/8"	16	7/16"	23.00	
38"	AR38G	38-1/8"	2"	2"	3/16"	40-3/8"	24	7/16"	24.50	
40"	AR40G	40-1/8"	2"	2"	3/16"	42-3/8"	24	7/16"	25.75	
42"	AR42G	42-1/8"	2"	2"	3/16"	44-3/8"	24	7/16"	26.50	
44"	AR44G	44-1/8"	2"	2"	3/16"	46-3/8"	24	7/16"	28.00	
46"	AR46G	46-1/8"	2"	2"	3/16"	48-3/8"	24	7/16"	29.00	
48"	AR48G	48-1/8"	2"	2"	3/16"	50-3/8"	24	7/16"	30.75	